

Installation Instructions

Profile shelf



Content:

Components, measurements, mounting

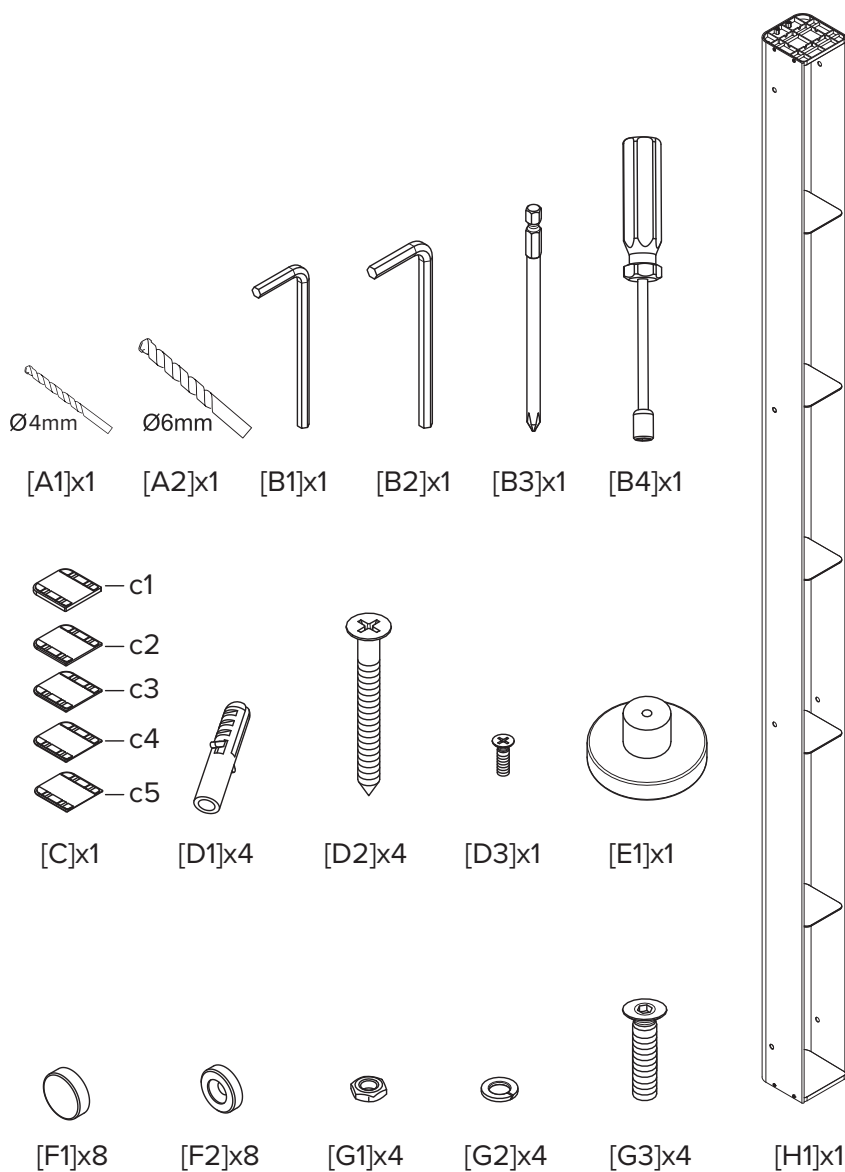

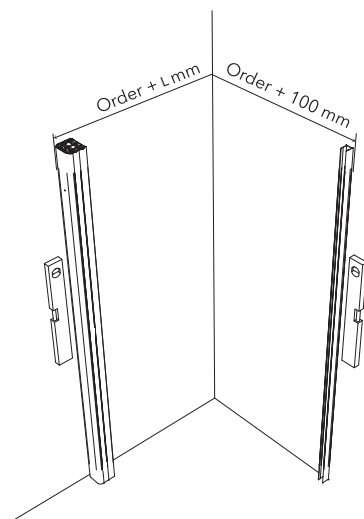
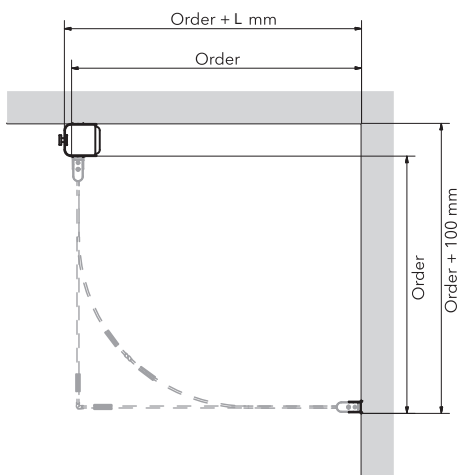

Look at the dimensions instructions in the manual for the shower wall to be mounted.

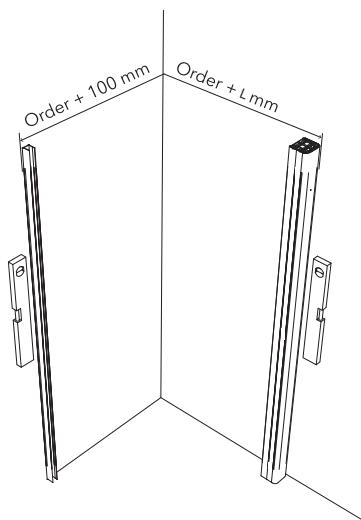
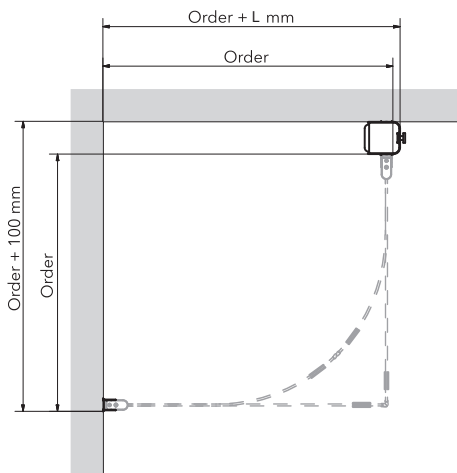

Order	L mm
	+20 mm

1. Mount the shelf on the wall

Fixing in the wet zone should be sealed with waterproof, mold and age-resistant sealing material

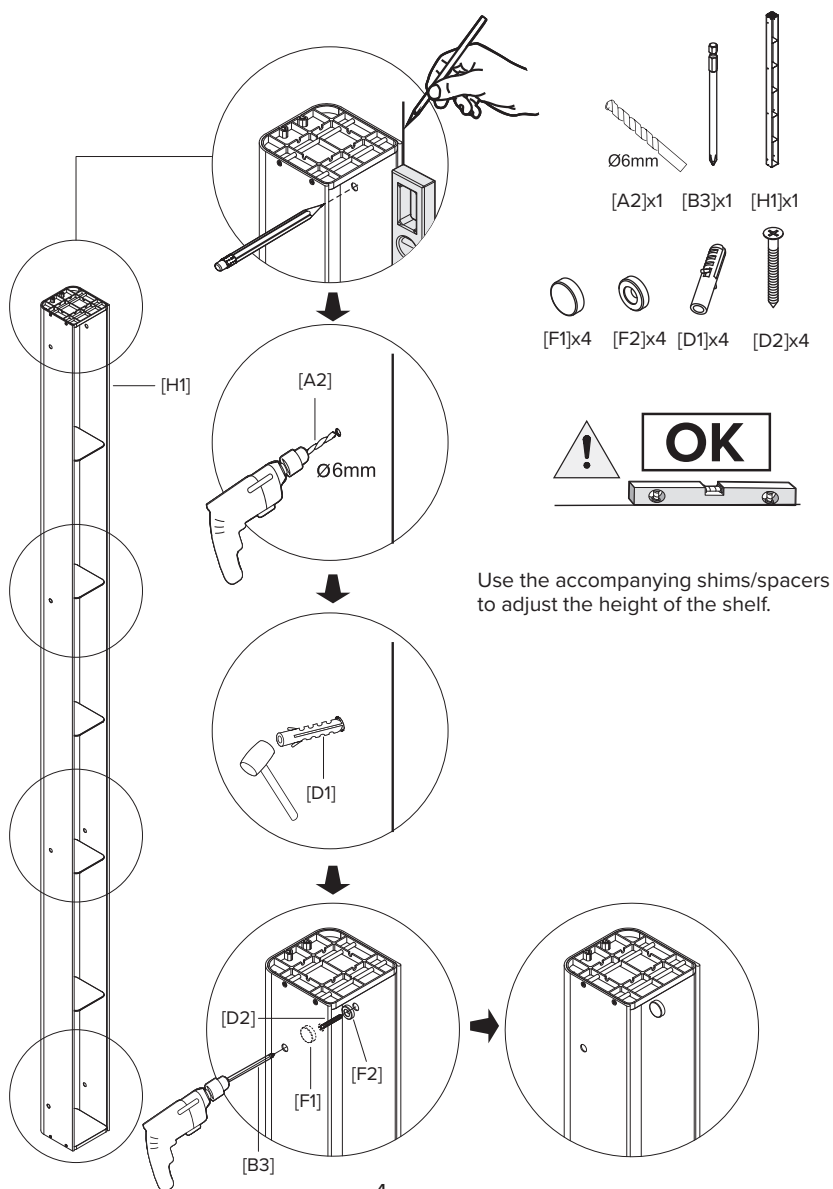

2. Mount the shower wall on the shelf

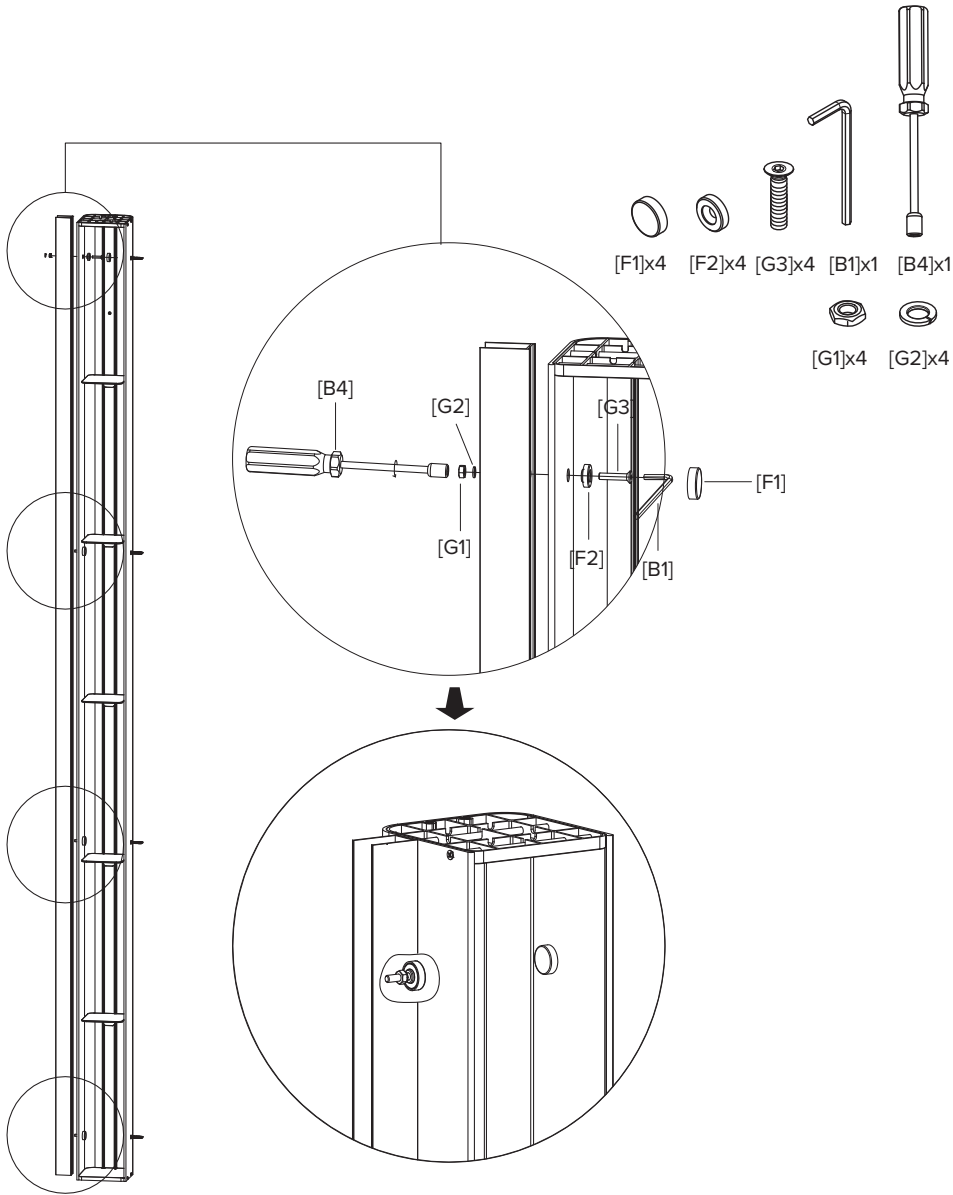

2. Mount the shower wall

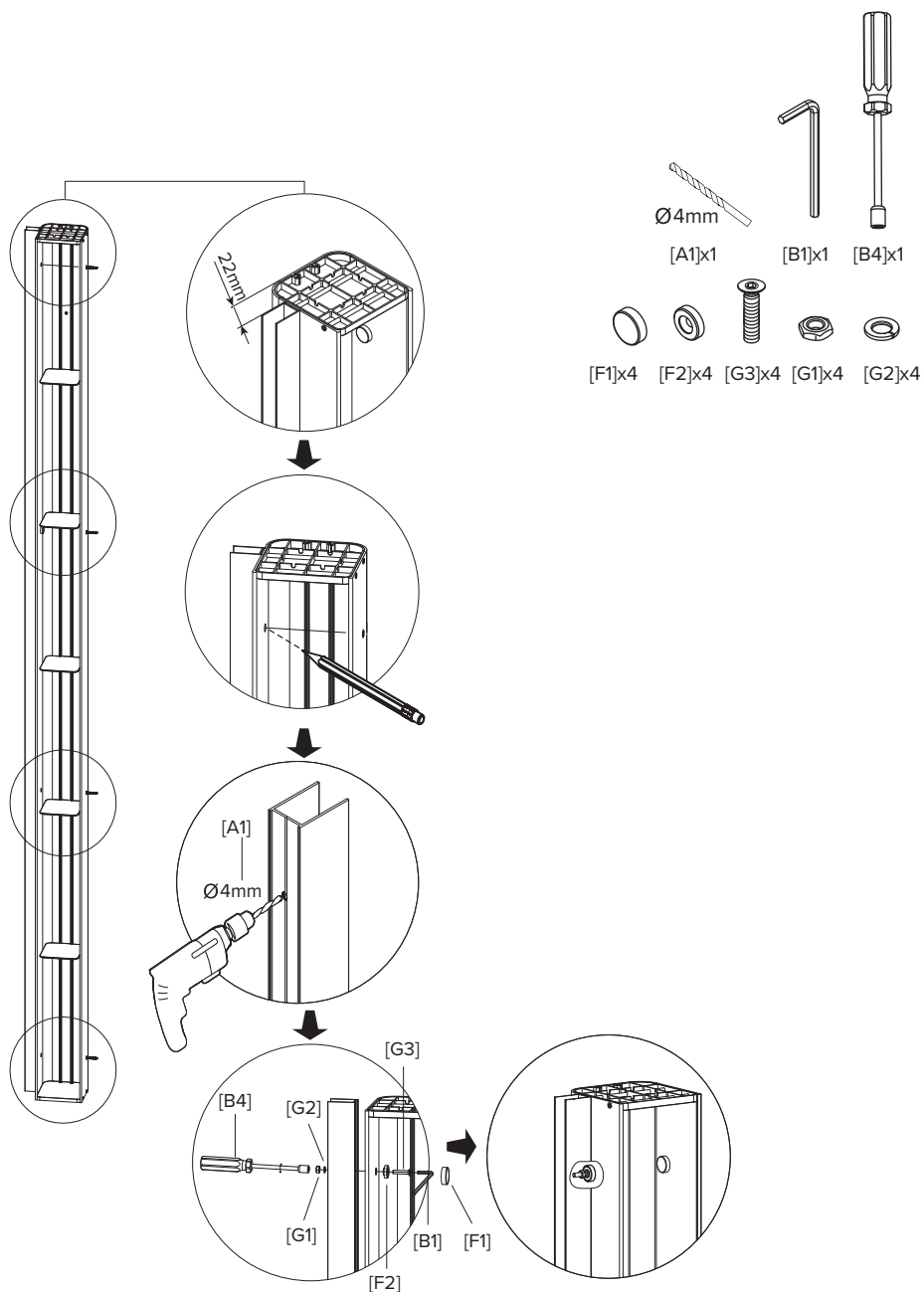

3. Mount the towel hook

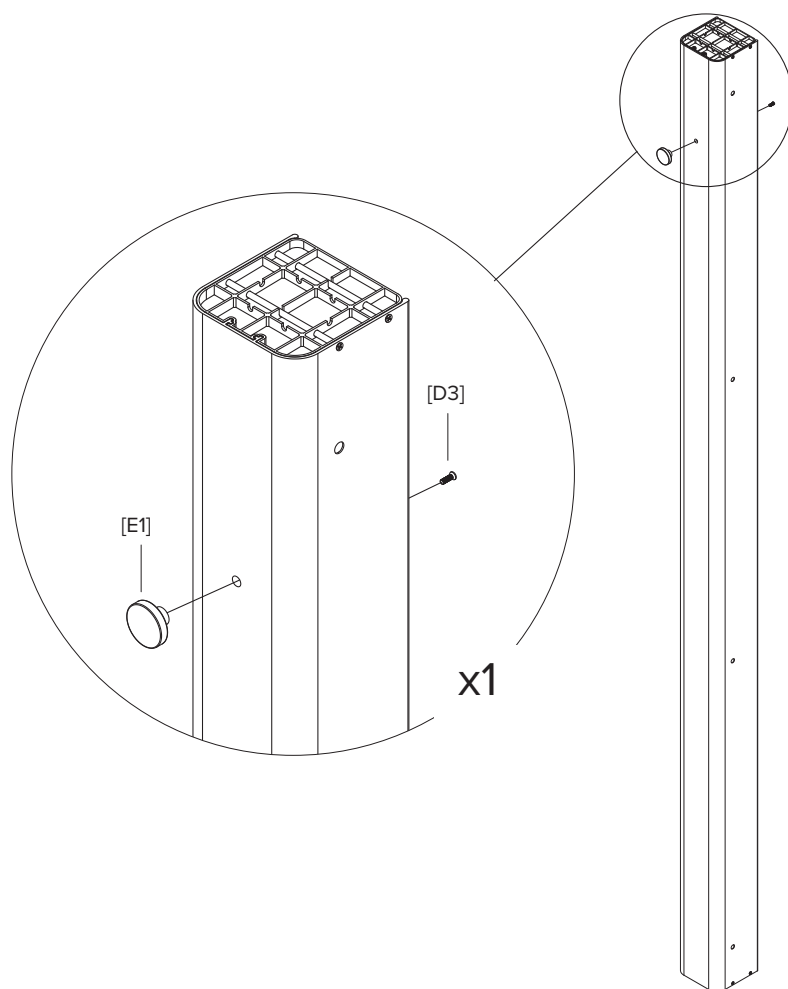
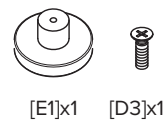

4. Adjust the placement of shelves



[B2]x1

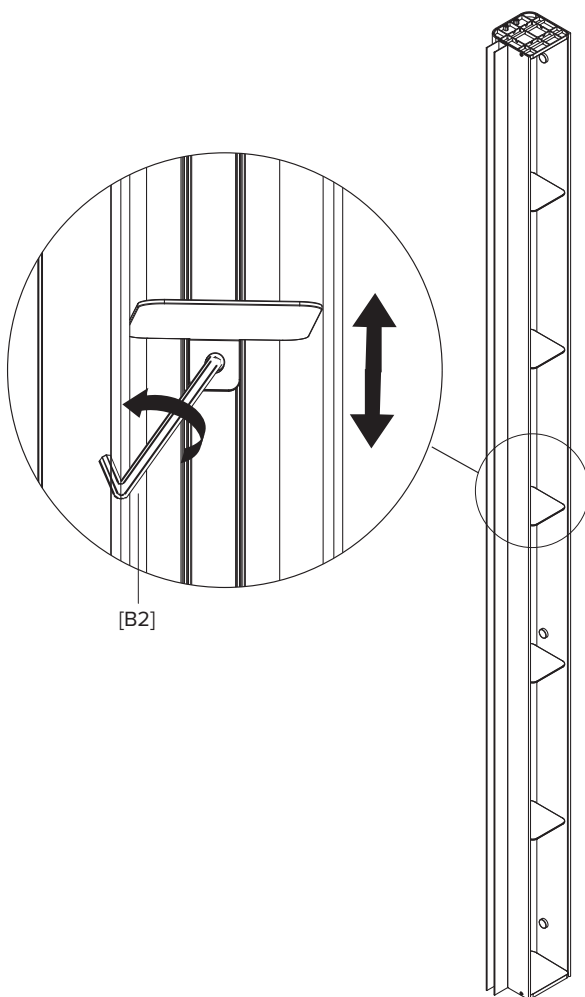

5. Silicone around the shelf

